

2014

WINDHOEK

52,572 m²

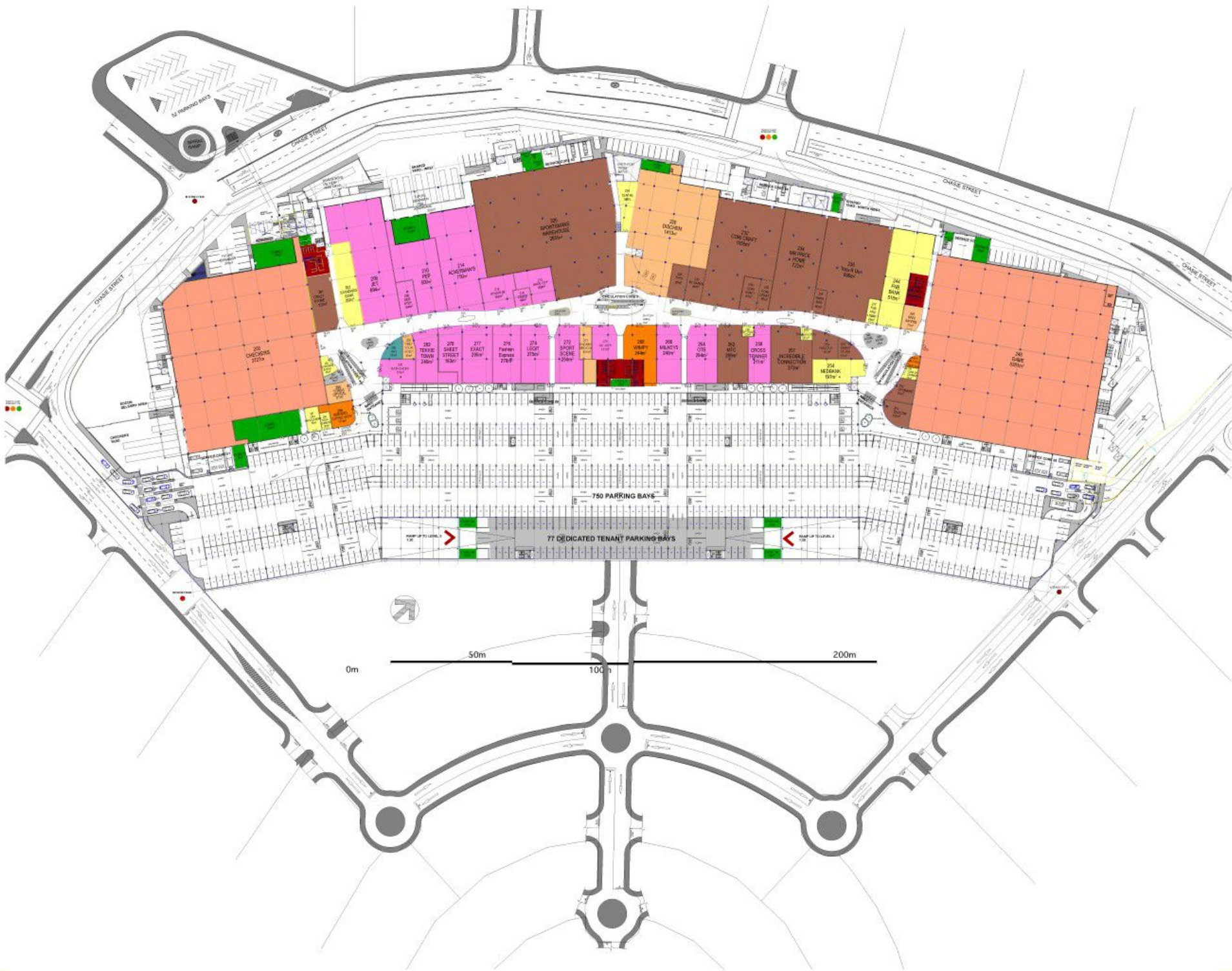



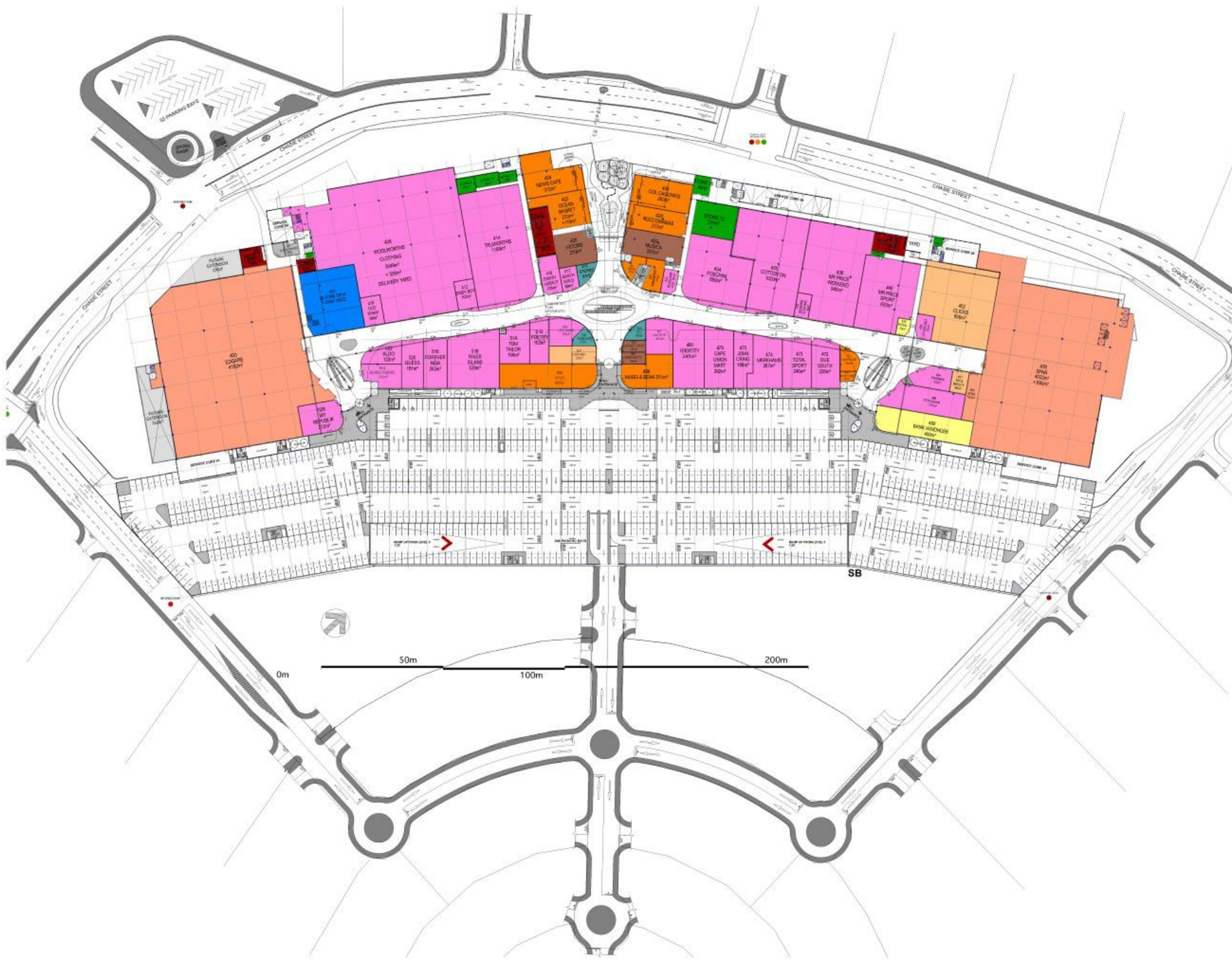

COPYRIGHT AND RIGHT OF REPRODUCTION OF THIS DRAWING OR ANY PORTION THEREOF IS RESERVED BY THE ARCHITECT

GENERAL NOTES

1. ALL DIMENSIONS ARE GIVEN UNLESS OTHERWISE STATED.
 2. DO NOT SCALE DRAWING.
 3. CONSULT WITH THE CONTRACTOR FOR ANY AMENDMENTS.
 4. ALL WORK TO BE DONE IN ACCORDANCE WITH THE NATIONAL BUILDING REGULATIONS (NBQR) OF 2012.

NO.	DATE	DESCRIPTION	BY
01	20.08.2018	ISSUE FOR APPROVAL	DD

NO.	DATE	DESCRIPTION	BY



GROVE MALL OF NAMIBIA (PTY) LTD



H&C
 HOWARD & CHAMBERLAIN
 PO BOX 19023 ALLEN PARKWAY, TOLL FREE 0800 125 088
 #ATTACHED @ #WINDHOLM CITY #WESTCOST COAST



LEASING PLANS
 LEVEL 4

FOR INFORMATION

NO.	DATE	DESCRIPTION	BY
315	20.08.2018	ISSUE FOR APPROVAL	DD